

**ZONING :**

PUD (PLANNED UNIT DEVELOPMENT)

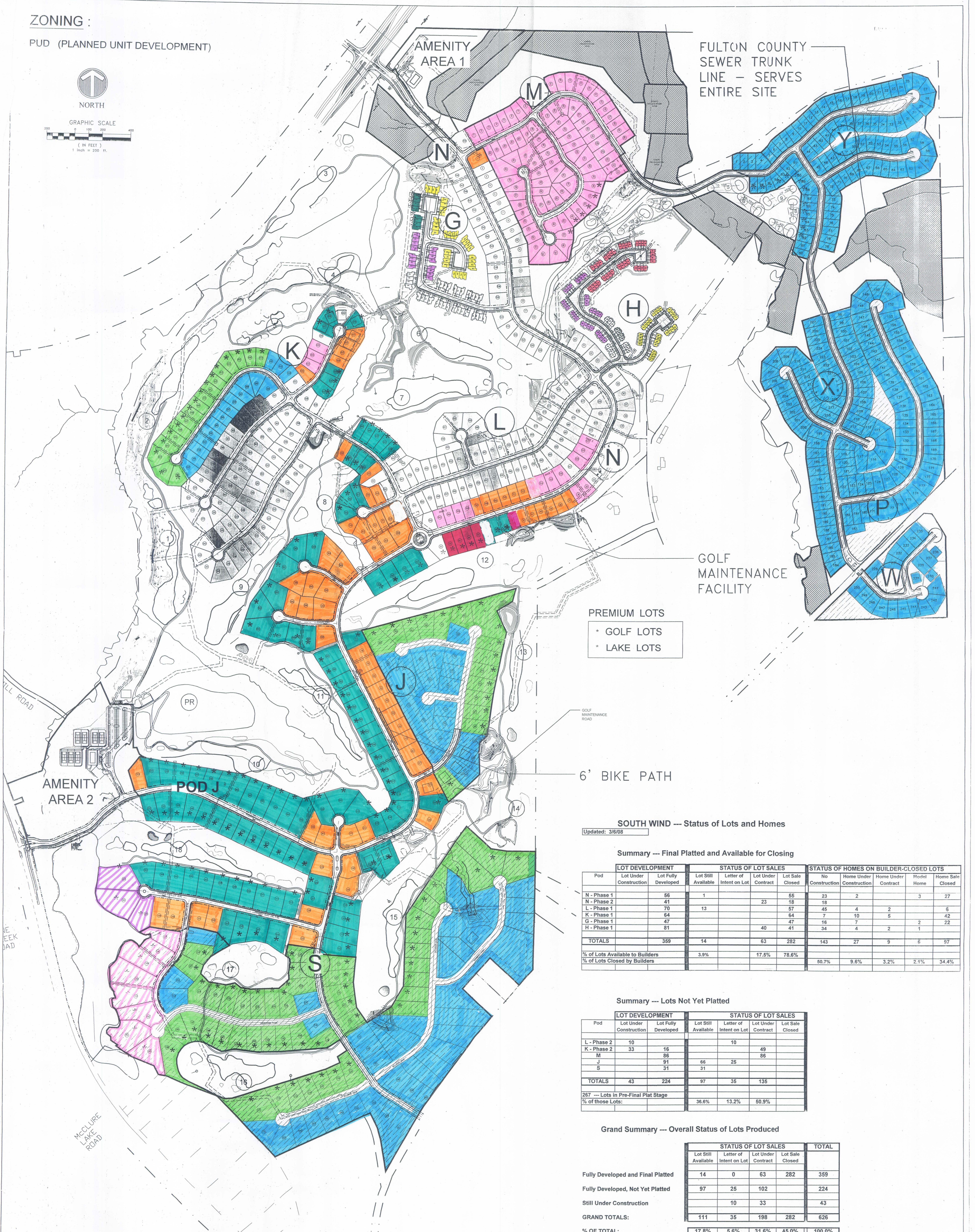
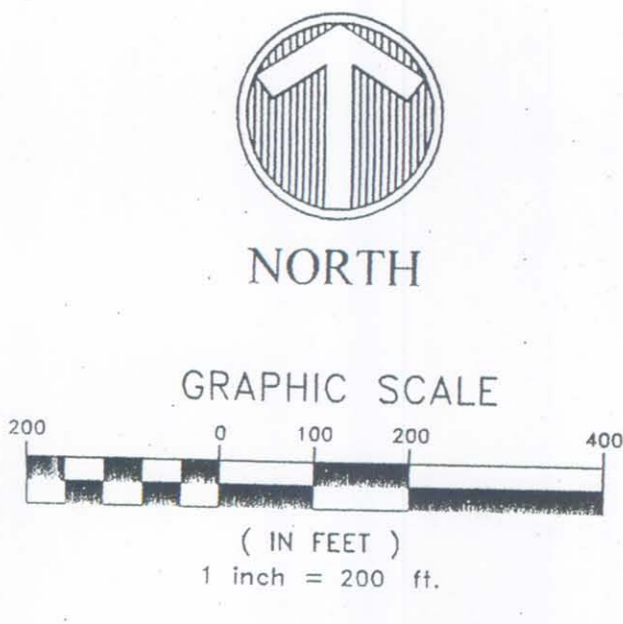

FULTON COUNTY  
SEWER TRUNK  
LINE - SERVES  
ENTIRE SITE

AMENITY  
AREA 1

GOLF  
MAINTENANCE  
FACILITY

PREMIUM LOTS

- \* GOLF LOTS
- \* LAKE LOTS

6' BIKE PATH

AMENITY  
AREA 2

POD J

**SOUTH WIND --- Status of Lots and Homes**

Updated: 3/6/08

**Summary --- Final Platted and Available for Closing**

Pod	LOT DEVELOPMENT		STATUS OF LOT SALES			STATUS OF HOMES ON BUILDER-CLOSED LOTS					
	Lot Under Construction	Lot Fully Developed	Lot Still Available	Letter of Intent on Lot	Lot Under Contract	Lot Sale Closed	No Construction	Home Under Construction	Home Under Contract	Model Home	Home Sale Closed
N - Phase 1	66		1			55	23	2		3	27
N - Phase 2	41				23	18					6
L - Phase 1	70		13			57	45	4	2		6
K - Phase 1	64					64	7	10	5		42
G - Phase 1	47					47	16	7		2	22
H - Phase 1	81				40	41	34	4	2	1	22
<b>TOTALS</b>	<b>359</b>		<b>14</b>		<b>63</b>	<b>282</b>	<b>143</b>	<b>27</b>	<b>9</b>	<b>6</b>	<b>97</b>
% of Lots Available to Builders			3.9%		17.5%	78.6%	60.7%	9.6%	3.2%	2.1%	34.4%
% of Lots Closed by Builders											

**Summary --- Lots Not Yet Platted**

Pod	LOT DEVELOPMENT		STATUS OF LOT SALES			
	Lot Under Construction	Lot Fully Developed	Lot Still Available	Letter of Intent on Lot	Lot Under Contract	Lot Sale Closed
L - Phase 2	10			10		
K - Phase 2	33	16		49		
M		86		86		
J		91	66	25		
S		31	31			
<b>TOTALS</b>	<b>43</b>	<b>224</b>	<b>97</b>	<b>35</b>	<b>135</b>	
267 --- Lots in Pre-Final Plat Stage						
% of those Lots:			36.6%	13.2%	60.9%	

**Grand Summary --- Overall Status of Lots Produced**

	STATUS OF LOT SALES				TOTAL
	Lot Still Available	Letter of Intent on Lot	Lot Under Contract	Lot Sale Closed	
Fully Developed and Final Platted	14	0	63	282	359
Fully Developed, Not Yet Platted	97	25	102		224
Still Under Construction		10	33		43
<b>GRAND TOTALS:</b>	<b>111</b>	<b>35</b>	<b>198</b>	<b>282</b>	<b>626</b>
<b>% OF TOTAL:</b>	<b>17.8%</b>	<b>5.6%</b>	<b>31.6%</b>	<b>45.0%</b>	<b>100.0%</b>

FALLING WATER  
INC.  
PRE-ENGINEERING

DATE: 03-05-08  
REVISIONS: LOT STATUS PLAN - REVIEW

BY: KSC

SOUTHWIND  
LOCATED LAND LOTS 94, 95, 113, 114, 115, 118, 119, 120  
OF DISTRICT 9F FULTON COUNTY, GA

LOT STATUS PLAN,  
CITY OF UNION CITY