

INSTRUCTION MANUAL Models: LumienARC (L3S1)

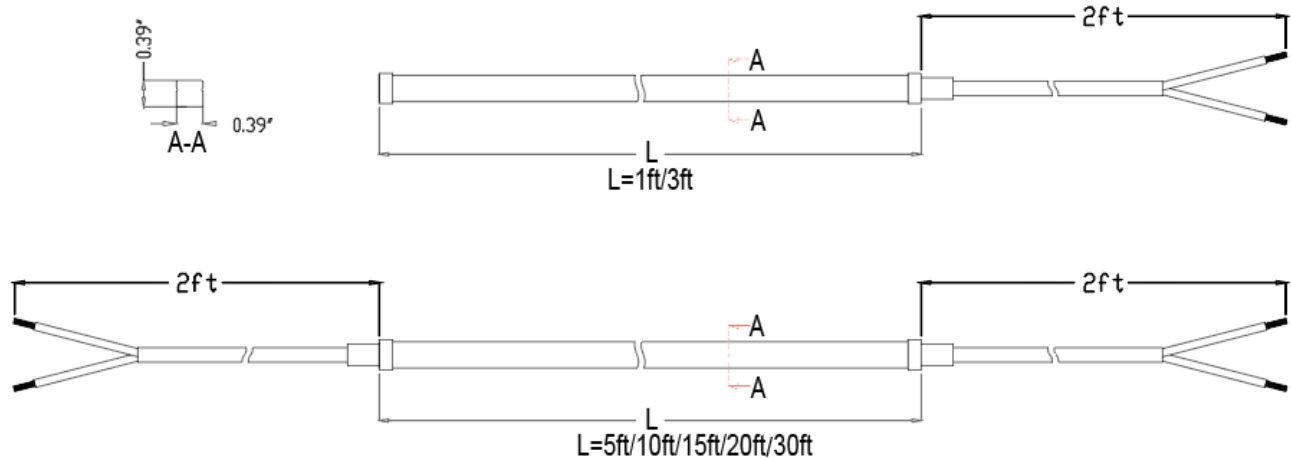

Item	Color / CCT	Lumen/FT	Power/FT	Voltage	Volt Amps/FT	Light efficiency	CRI (Ra)	Max.Run (single end feed)	Minimum section	Color Tolerance
L3S1-1-2W-27K-WH L3S1-3-6W-27K-WH L3S1-5-10W-27K-WH L3S1-10-20W-27K-WH L3S1-15-30W-27K-WH L3S1-20-40W-27K-WH L3S1-30-60W-27K-WH	2700K	72LM	2W	12VAC	2.28VA	36LM/W	80+	30 feet	2.81inch	SDCM<5
L3S1-1-2W-30K-WH L3S1-3-6W-30K-WH L3S1-5-10W-30K-WH L3S1-10-20W-30K-WH L3S1-15-30W-30K-WH L3S1-20-40W-30K-WH L3S1-30-60W-30K-WH	3000K	76LM	2W	12VAC	2.28VA	38LM/W	80+	30 feet	2.81inch	SDCM<5

OVERVIEW

Product Description:

- Dimension: 0.39" X 0.39"
- Constant voltage, Max run (single end feed) 30 ft, 2.81" as min section
- Matte treatment, smooth surface and resistant to dust
- 5, 10, 15, 20 and 30ft have double leads

Product Features:

- Always keep a factory seal
- Can be cut as small as 2.81"
- Can be installed both as rigid and flexible
- Dimmable
- IP67 Rating
- 5 Year Warranty

INSTALLATION ACCESSORIES

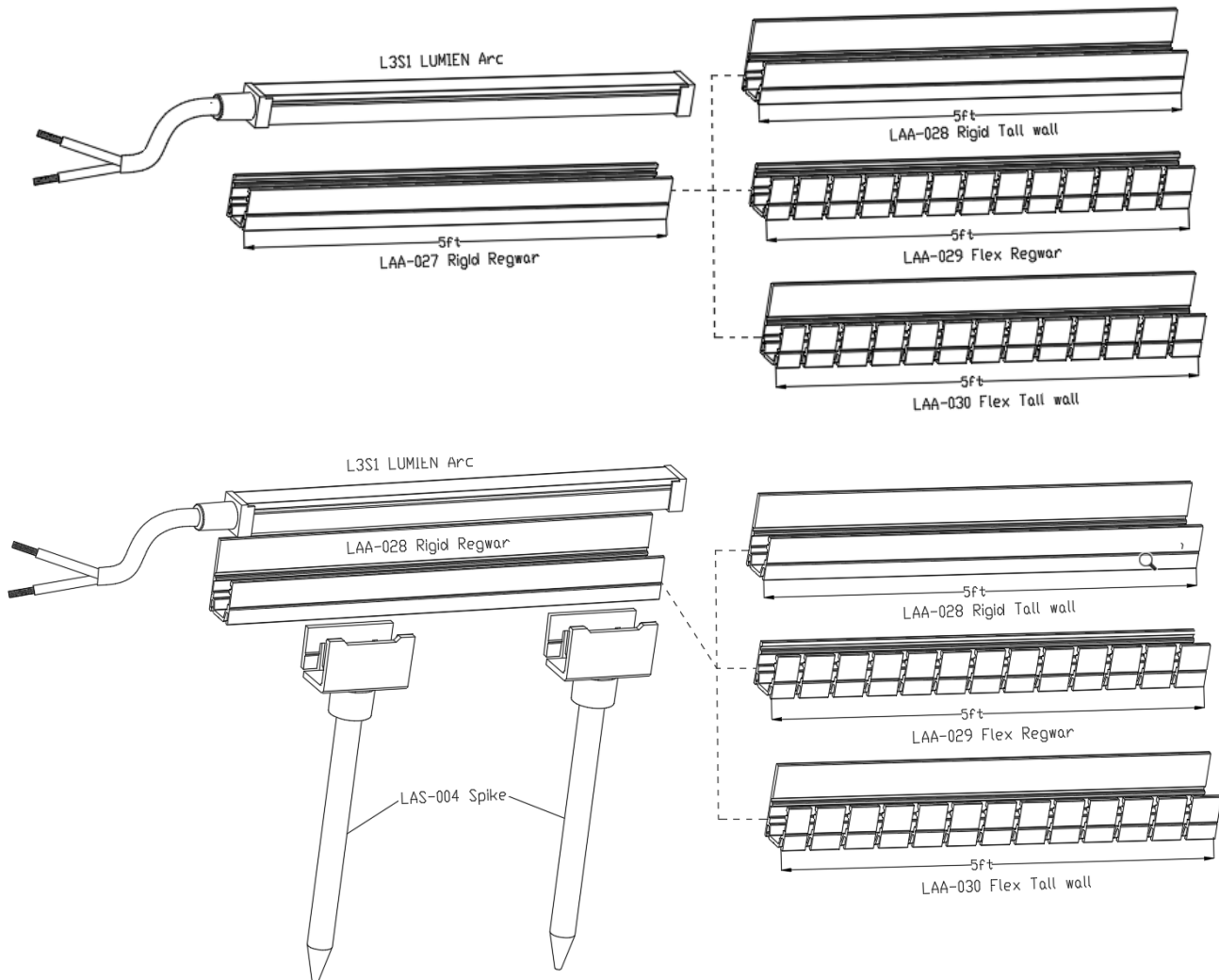

- LumienARC (L3S1) provides four (4) mounting bracket options:
 - Rigid Regular Wall (LAA-027)
 - Rigid Tall Wall (LAA-028)
 - Flex Regular Wall (LAA-029)
 - Flex Tall Wall (LAA-030)
- The LumienARC ground stake (LAS-004) is to be used in conjunction with the mounting channels. Install as shown in the figure above.

SPLICE ACCESSORIES

Cutter Tool

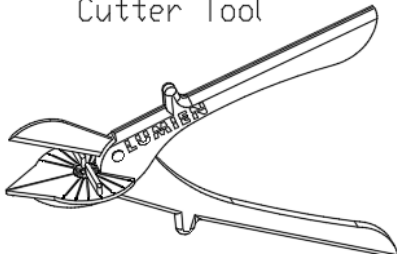

End Cap

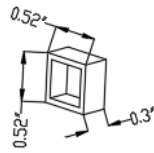

Wire Cap

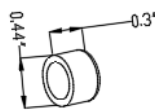

Silicon glue

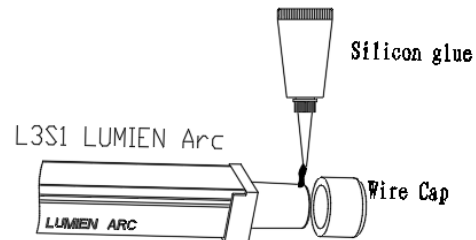
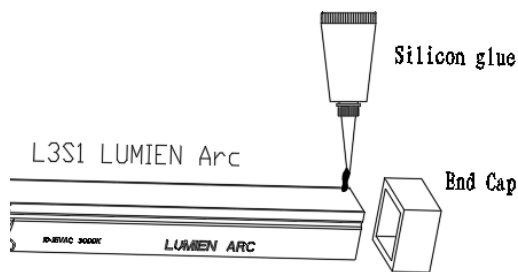
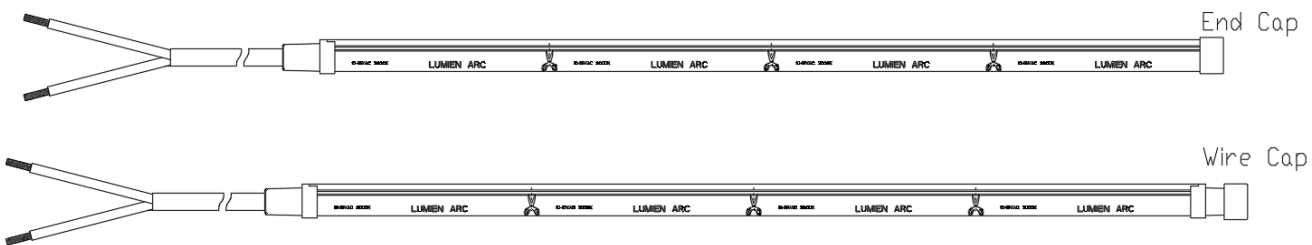

- When cutting the L3S1, please pay close attention to the dotted lines on the underside of the flex light.
- When bonding the End Cap and the Wire Cap, the glue should cover the entire circle.

LUMIEN FLEX STRIP INSTRUCTION AND CAUTION

Light Profile

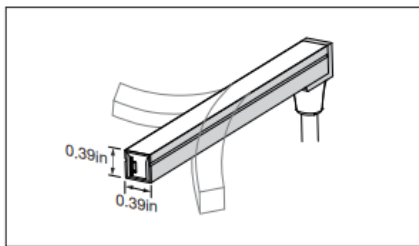

Bending Direction

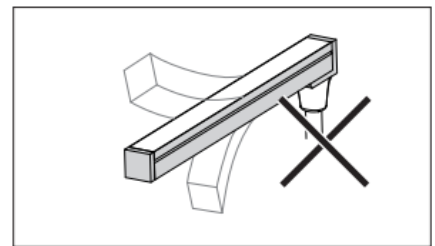
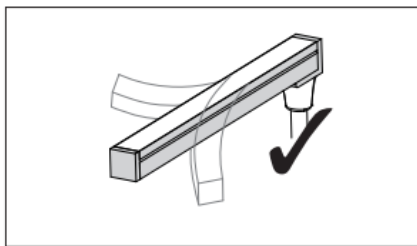

Correct Bending Way

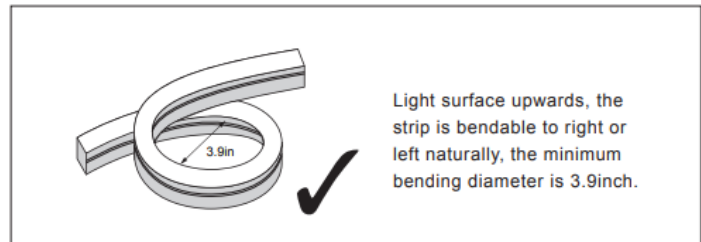
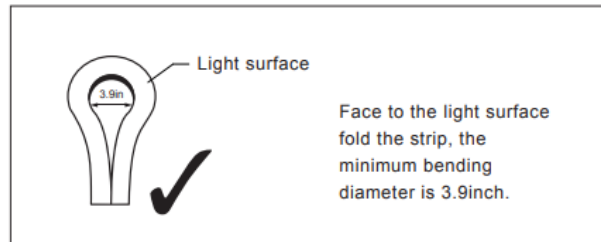

Incorrect Bending Way

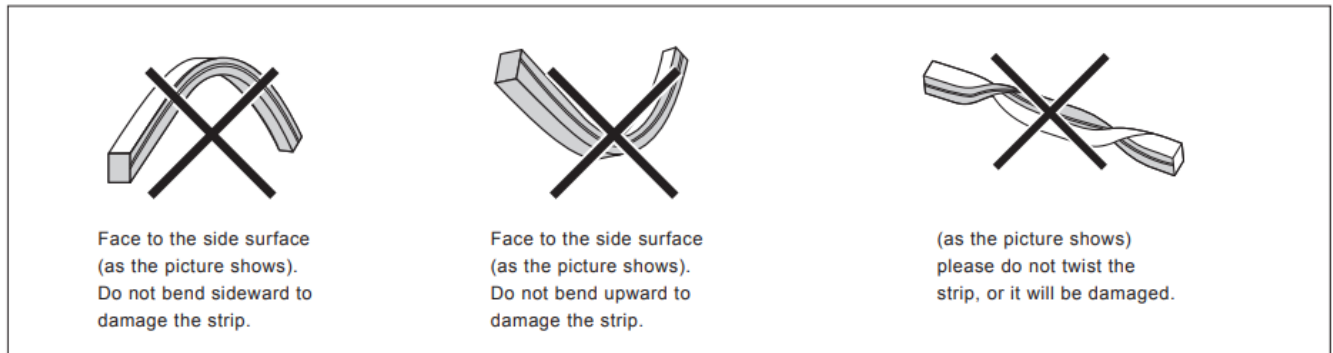

WARNING – TO REDUCE THE RISK OF FIRE OR INJURY TO PERSON:

- Turn off/unplug the fixture and allow it to cool before handling; making any adjustments or repairs or replacing the integrated light module.
- Integrated light module gets HOT quickly. Only touch the switch/plug when turning it on.
- Do not touch the lens, guard, or enclosure when hot.
- Keep integrated light module away from materials that could ignite/ combust/ burn.
- Do not touch the integrated light module chip at any time. Use a soft cloth. The oils from skin could damage LED.
- Do not operate the fixture with a missing or damaged securing lens cap (part C).

WARNING – RISK OF ELECTRIC SHOCK:

- Install it in accordance with all local codes and ordinances.
- Install all luminaires at least 10 feet (3.05 m) from a pool, spa, fountain, etc.
- A fixture shall not use tungsten halogen lamps unless the luminaire is marked for such lamp.

IMPORTANT

TRANSFORMER

- Install it in accordance with all local codes and ordinances.
- Only use a UL1838 transformer for safety reasons and to ensure full lifespan of the fixture.
- Ensure that the transformer is plugged in to a GFCI protected circuit.



FIXTURE

DO NOT EXCEED 15 VOLTS IN THIS FIXTURE

- Install it in accordance with all local codes and ordinances.
- This fixture functions best when the incoming voltage is between 10–15 volts. Voltages outside of this range could damage the fixture, shorten the life, and cause unsatisfactory performance. The use of improper voltage voids the product warranty.

LOW VOLTAGE CABLE

- Install it in accordance with all local codes and ordinances.
- Be protected by routing near the luminaire, or next to a building structure such as a house or deck.
- Not to be buried except for a maximum of 6 inches (15.2 cm) to connect to the main low voltage cable.
- Have the length cut off so that it is connected to a connector within **6 inches (15.2 cm) from a building structure, a luminaire, or fitting.**

It is ***not recommended*** to use Quick Clip style connectors because they are not waterproof and can not creating resistance and shorts. Only use outdoor rated waterproof wire connectors. Install it in accordance with all local codes and ordinances.

LED LIFE

- For maximum light output, adjust lighting circuits to provide between 10-15 volts.
- Voltage can be regulated by adjusting circuit load/run.
- To determine circuit voltage, use a digital voltmeter at the fixture.

LIMITED WARRANTY

WHAT IS COVERED

The manufacturer warrants this lighting fixture to be free from defects in materials and workmanship from date of purchase for a period of ten (5) years for Aluminum and Lifetime for Brass. This warranty applies only to the original consumer purchaser and only to products used in normal use and service. If this product is found to be defective, the manufacturer's only obligation, and your exclusive remedy, is the repair or replacement of the product at the manufacturer's discretion, provided that the product has not been damaged through misuse, abuse, accident, modification, alteration, neglect, or mishandling.

WHAT IS NOT COVERED

This warranty shall not apply to any product that is found to have been improperly installed, set-up, or used in any way not in accordance with the instructions supplied with the product. This warranty shall not apply to a failure of the product because of an accident, misuse, abuse, negligence, alteration, faulty installation, or any other failure not relating to faulty material or workmanship. This warranty shall not apply to the finish on any portion of the product, such as surface and/or weathering, finish defects or fusing of the metals are considered normal wear and tear due to proximity to harsh environments; this includes but is not limited to coastal areas, ground water (minerals and impurities) and chemicals used in the landscape. The manufacturer does not warrant and especially disclaims any warranty, whether expressed or implied, of fitness for a purpose, other than the warranty contained herein. The manufacturer specifically disclaims any liability and shall not be liable for any consequential or incidental loss or damage, including but not limited to any labor/expense costs involved in the replacement or repair of said product.