



INSTRUCTION MANUAL

Item

LP-REMOTE

LumienPRO Remote Control

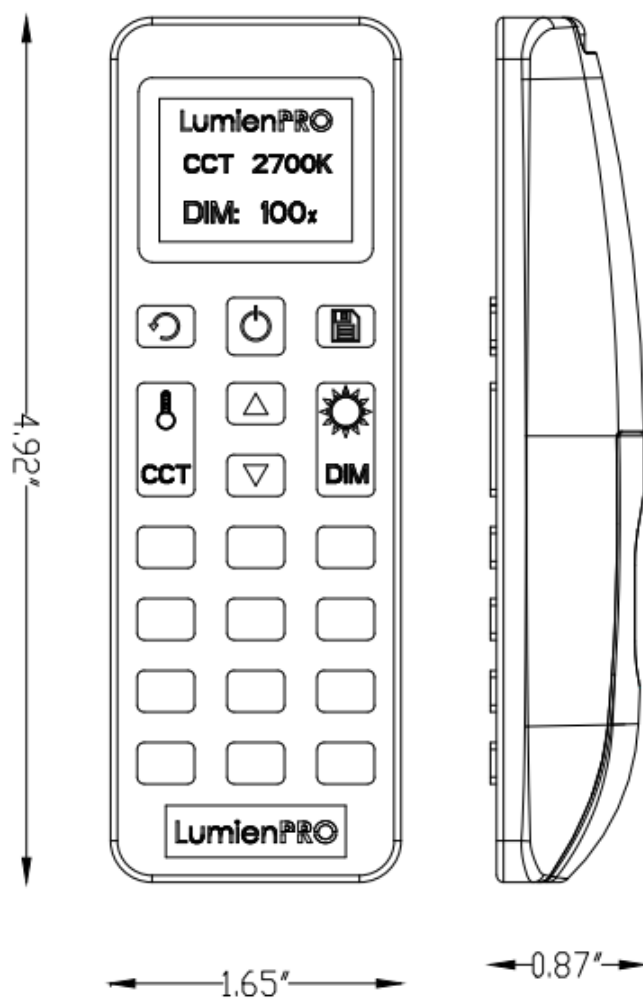

Remote Control Key Functions

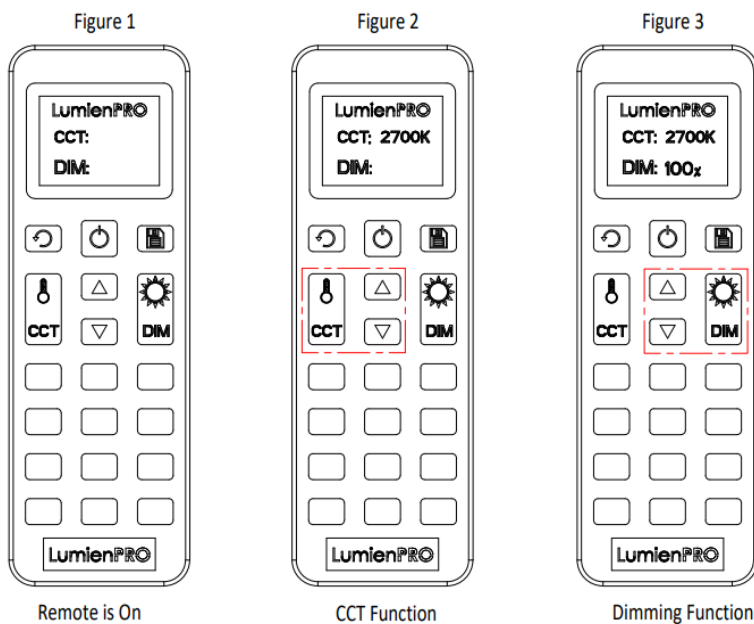
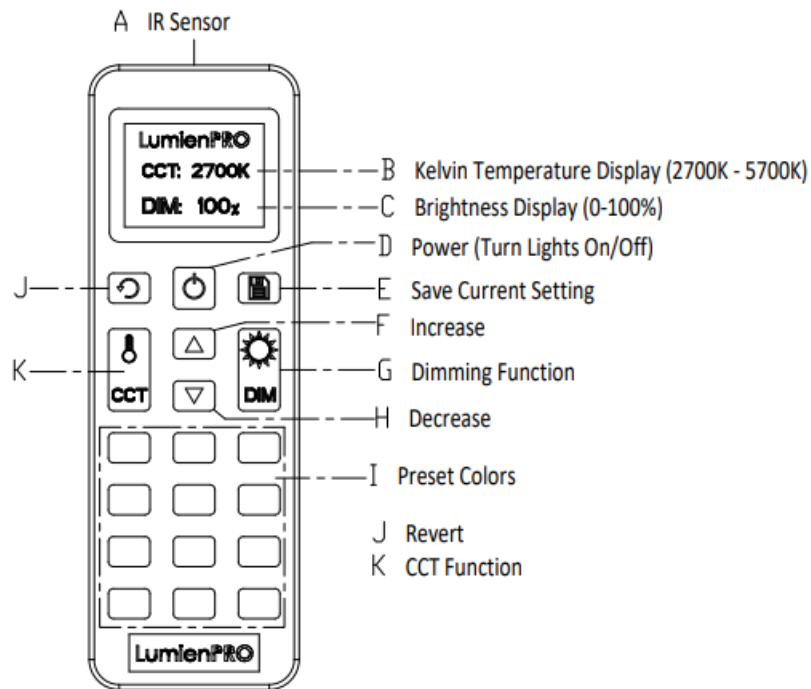

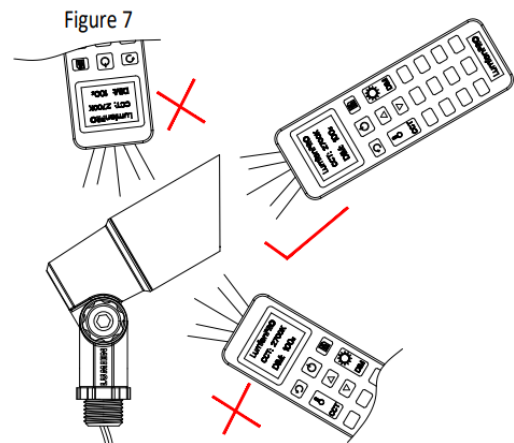
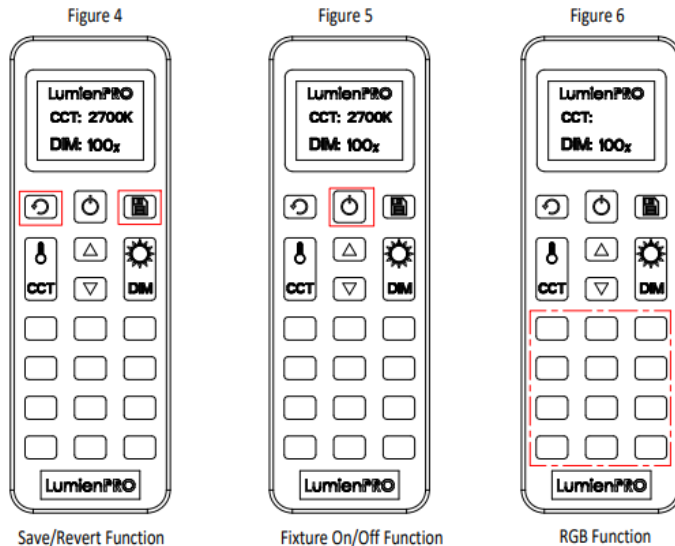

Instructions:

1. Open the back cover of the remote and insert (2) AAA batteries (Not Included) to power on. When remote turns on, the screen displays as shown in Figure 1.
2. To use the LumienPRO remote, the IR transmitter should be pointed at the LED chip. (Shown in Figure 7)
3. Press the power button (D) to turn the fixture on and off. (Figure 5)
4. To adjust kelvin temperature: Press the CCT button (K). The screen example is shown in Figure 2. Then, use the up & down arrows (F & H) to adjust in increments of 30 or hold them down to adjust the kelvin setting faster.
5. To adjust to brightness: Press the DIM button (G). the screen example is shown in Figure 3. Then, use the up & down arrows (F & H) to adjust the brightness in increments of 1%. Hold the arrow keys down to adjust brightness at a faster speed. To quickly jump to 100%, hold the DIM button (G) for 8 seconds.
6. Once you have fine-tuned your fixture to all necessary settings, hold down the Save button (E) for 5 seconds. The fixture will flash to indicate that the settings are saved. (Figure 4)
7. If any settings are changed (example: A RGB color was selected), you can press the "Revert" button (J) once to put your fixture back to the most recent saved settings in Step 6. (Figure 4)
8. To select a Preset Color Option, press any color key (I) to instantly change to the desired color. (Figure 6)
9. The remote will go to sleep after 1 minute of no use. To activate the remote, press any key.